

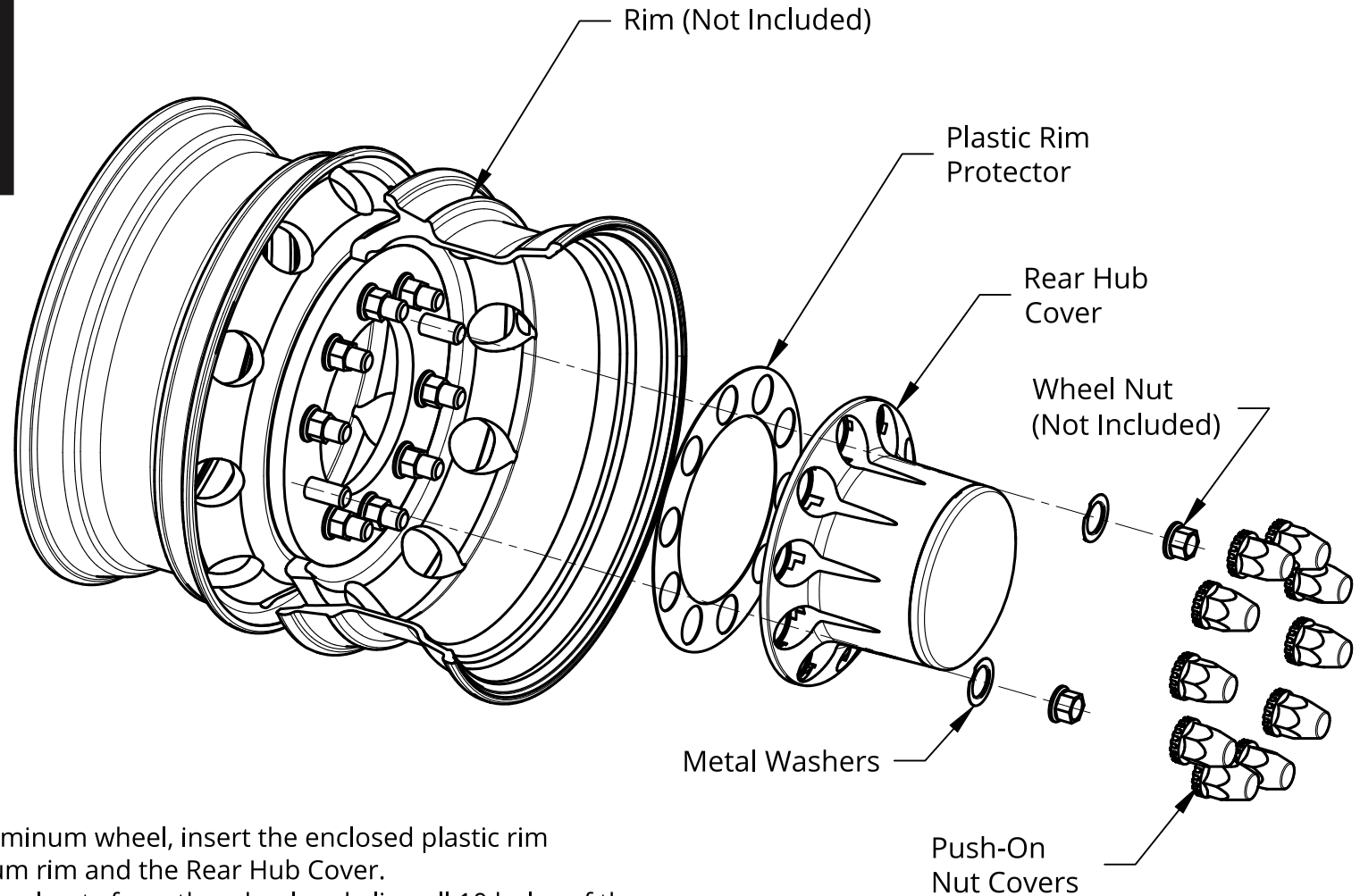

United Pacific



### Installation Guide:

1. For installation on an aluminum wheel, insert the enclosed plastic rim protector between the aluminum rim and the Rear Hub Cover.
2. Remove two opposite wheel nuts from the wheel and align all 10 holes of the cover over the studs and nuts.
3. Install one metal washer over each stud with the removed wheel nut by inserting the tab into the inner guide hole so that the washer lays flat side up. (The raised surface of the washer should face the inside rim of the hole.)
4. Re-install the Wheel Nuts over the metal washers.
5. Install Push-On Nut Covers on each nut by pushing until the nut cover is flush with the inside rim of the hole. Nut cover should now be secure on each nut.

CAUTION: THE PLASTIC RIM PROTECTOR MUST BE USED WHEN THIS PRODUCT IS PLACED ON ANY ALUMINUM RIM TO PREVENT COSMETIC DAMAGE ON THE SOFT ALUMINUM RIM. UNITED PACIFIC SHALL NOT BE RESPONSIBLE FOR IMPROPER INSTALLATION OF THE PRODUCT.

Item No. 10316/10362/10365/10366  
Product Name:  
Rear Axle Cover With 33mm  
Standard Style Push-On Nut Covers

Rev No. 07212022