



United Pacific

# LED GEARSHIFT KNOB MOUNTING INSTRUCTION

Item # 70712-70743

1. Remove screws and gearshift knob off OE gearshift. Be careful not to lose any components from the inside of the OE gearshift.



2. Unscrew the hex screws and remove the chrome top adaptor from the adaptor base.



3. Screw the adaptor base onto the OE gearshift using OE screws.

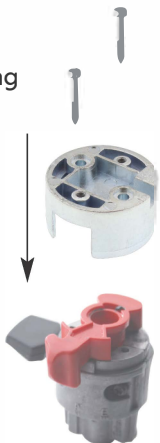

4. Slide the chrome top adaptor onto the adaptor base. Tighten the chrome top to the bottom adaptor base with the hex screws.



5. Insert the grip onto the chrome top adaptor and tighten the set screws securely.

